

Wilmaplex Pty Ltd.
57 Lathams Road,
Carrum Downs, Vic 3201
Mr Graham storey

RE/ Wilmaplex Cyclone Tie Design Capacity

This is to confirm that Wilmaplex commissioned CEMQA Pty. Ltd. to undertake the task of evaluating the design capacity via testing or computation of 1mm G300 Z275 Cyclone Tie (CT600MM and CT400MM). The evaluation was carried out via testing and computations. Wilmaplex 3.15x35mm galvanized hand driven ring shank flat head nails were used. Design capacities are given in Table 1. Figure 1.

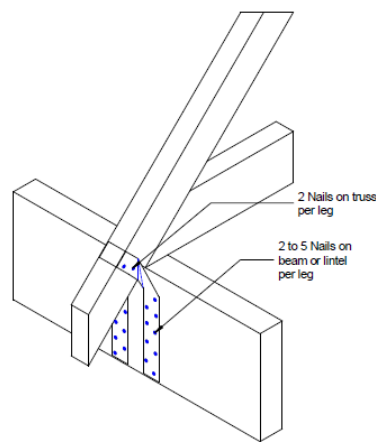

Figure 1 Cyclone Tie face fixed application.

Table 1 Single Wilmaplex Cyclone Tie resisting wind uplift capacities

Nails per leg	Design capacity (ϕN_j) for timber joint (JD4) using Wilmaplex Cyclone Tie
2	2.9
3	4.3
4	5.7
5	7.1

Notes:

1. Wind uplift capacities were determined using a duration factor of $k_1=1.14$ based on AS/NZS1170 and AS1720.1.

Dr Con Adam (Director)
CEMQA Pty. Ltd.
P.O. Box 2660
Mt. Waverley, VIC 3149